

Wall SHERATON VANCOUVER
WALL CENTRE | 

FLOOR PLANS AND FUNCTION SPACE

SOUTH TOWER

NORTH TOWER



THIRD FLOOR

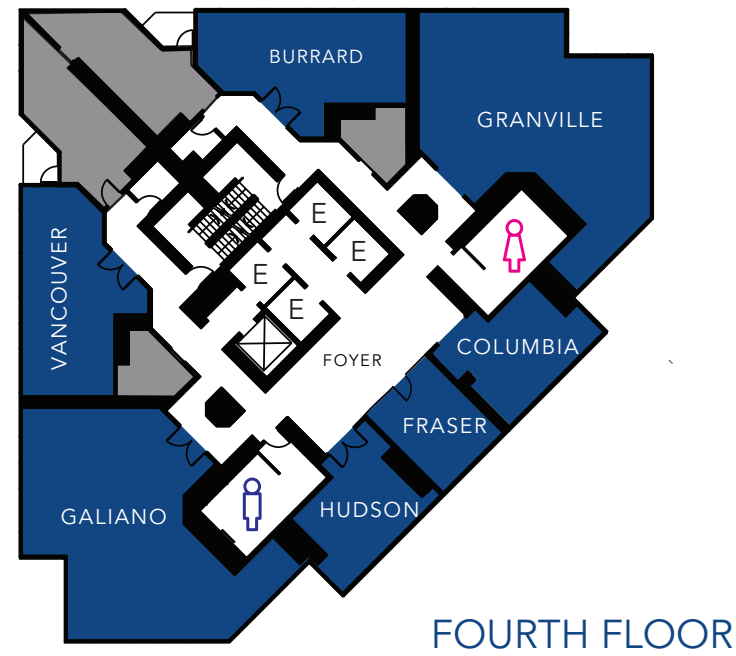

FOURTH FLOOR

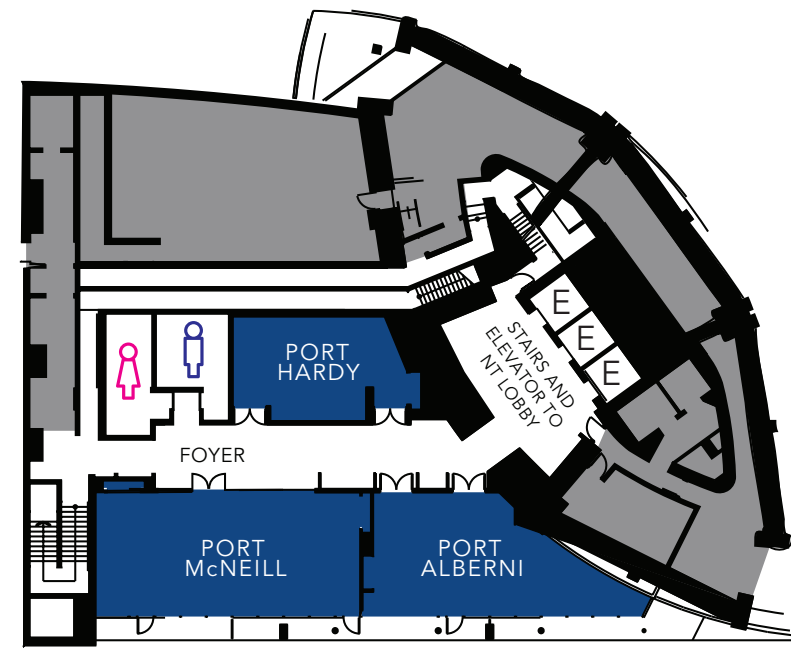

FOURTH FLOOR

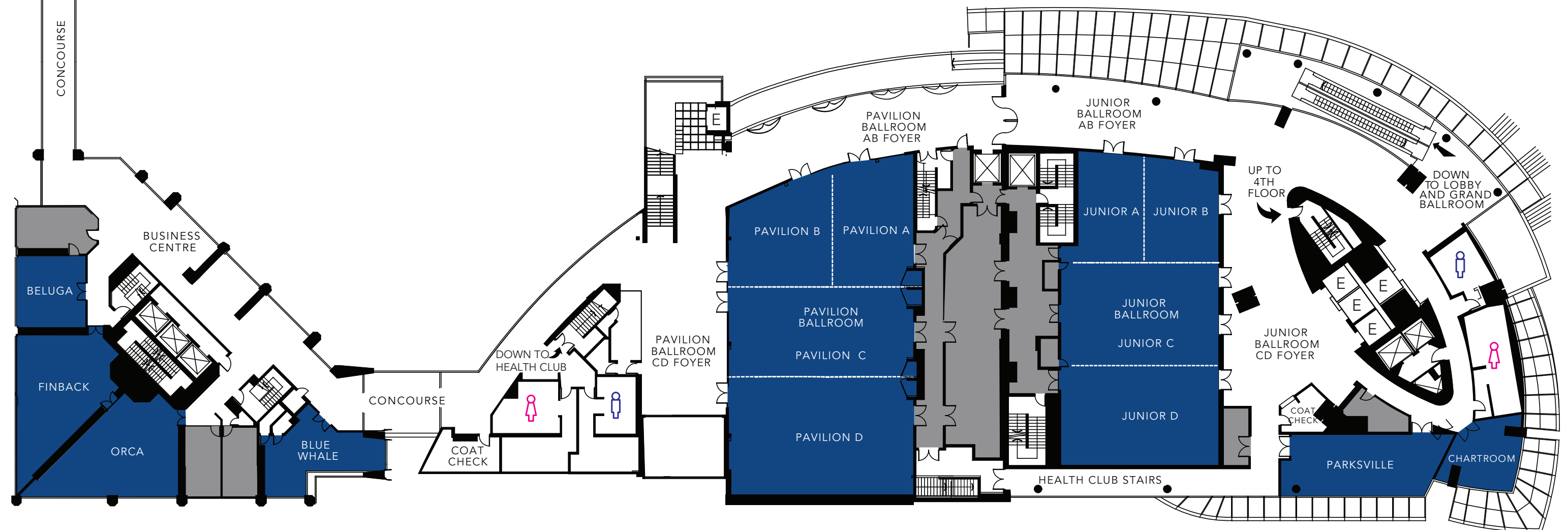

| Name | SQ.FT./SQ.M. | Height | Banquet | Reception | Theatre | Classroom | Boardroom | U-Shape | Hollow Square |
|-------------------------------|--------------|--------|---------|-----------|---------|-----------|-----------|---------|---------------|
| Pavilion Ballroom | 5,055 / 470 | 18 | 400 | 500 | 636 | 276 | 90 | 96 | 108 |
| Pavilion Ballroom + Foyer | 8,581 / 797 | -- | 450 | 650 | -- | -- | -- | -- | -- |
| Pavilion Ballroom A | 858 / 80 | 18 | 70 | 80 | 84 | 44 | 24 | 30 | 30 |
| Pavilion Ballroom B | 892 / 83 | 18 | 60 | 80 | 95 | 51 | 30 | 30 | 36 |
| Pavilion Ballroom C | 1,420 / 132 | 18 | 100 | 150 | 140 | 72 | 42 | 48 | 54 |
| Pavilion Ballroom D | 1,892 / 176 | 18 | 140 | 200 | 224 | 96 | 42 | 48 | 60 |
| Pavilion Ballroom AB | 1,747 / 162 | 18 | 130 | 160 | 185 | 81 | 42 | 42 | 48 |
| Pavilion Ballroom CD | 3,312 / 308 | 18 | 270 | 400 | 364 | 192 | 54 | 63 | 78 |
| Pavilion Ballroom ABC | 3,167 / 294 | 18 | 270 | 320 | 355 | 165 | 48 | 54 | 72 |
| Pavilion Ballroom ABC + Foyer | 6,693 / 622 | -- | 310 | 320 | 355 | 165 | 48 | 54 | 72 |
| Pavilion Ballroom Foyer | 3,526 / 328 | 19 | -- | 250 | -- | -- | -- | -- | -- |
| Blue Whale | 409 / 38 | 8 | 20 | 20 | 20 | -- | 12 | -- | -- |
| Orca | 859 / 80 | 8 | 50 | 70 | 70 | 33 | 24 | 24 | 24 |
| Finback | 848 / 79 | 8 | 50 | 70 | 70 | 33 | 24 | 24 | 24 |
| Beluga | 416 / 39 | 8 | 30 | 40 | 40 | 16 | 16 | 12 | 18 |
| Azure | 1,364 / 127 | 8 | 70 | 100 | 65 | 28 | 36 | -- | -- |
| Cracked Ice | 690 / 64 | 8 | 30 | 40 | 30 | 12 | 20 | 12 | 18 |
| Name | SQ.FT./SQ.M. | Height | Banquet | Reception | Theatre | Classroom | Boardroom | U-Shape | Hollow Square |
| Junior Ballroom | 4,190 / 389 | 10 | 300 | 400 | 490 | 270 | 84 | 93 | 102 |
| Junior Ballroom + Foyer | 10,170 / 945 | -- | -- | 550 | -- | -- | -- | -- | -- |
| Junior Ballroom A | 629 / 58 | 10 | 50 | 60 | 60 | 30 | 24 | 24 | 24 |
| Junior Ballroom B | 682 / 63 | 10 | 50 | 60 | 63 | 30 | 24 | 24 | 30 |
| Junior Ballroom C | 1,344 / 125 | 10 | 110 | 130 | 144 | 84 | 36 | 42 | 48 |
| Junior Ballroom D | 1,534 / 143 | 10 | 120 | 130 | 168 | 84 | 36 | 45 | 54 |
| Junior Ballroom AB | 1,312 / 122 | 10 | 110 | 130 | 130 | 76 | 30 | 36 | 42 |
| Junior Ballroom CD | 2,878 / 267 | 10 | 210 | 260 | 288 | 162 | 54 | 63 | 78 |
| Junior Ballroom ABC | 2,656 / 247 | 10 | 210 | 300 | 300 | 150 | 48 | 60 | 66 |
| Junior Ballroom Foyer | 5,979 / 555 | 22 / 8 | -- | 150 | -- | -- | -- | -- | -- |
| Parksville | 887 / 82 | 8 | 50 | 60 | 84 | 45 | 36 | 26 | -- |
| Chartroom | 286 / 27 | 8 | -- | -- | -- | -- | 10 | -- | -- |
| Name | SQ.FT./SQ.M. | Height | Banquet | Reception | Theatre | Classroom | Boardroom | U-Shape | Hollow Square |
| Granville | 1,134 / 105 | 8 | 50 | 70 | 70 | 30 | 30 | 28 | 30 |
| Galiano | 1,125 / 105 | 8 | 50 | 70 | 70 | 30 | 30 | 28 | 30 |
| Burrard | 513 / 48 | 8 | 30 | 30 | 30 | 12 | 20 | -- | -- |
| Vancouver | 499 / 46 | 8 | 30 | 30 | 30 | 12 | 20 | -- | -- |
| Columbia | 328 / 30 | 8 | -- | -- | -- | -- | 10 | -- | -- |
| Hudson | 316 / 29 | 8 | -- | -- | -- | -- | 10 | -- | -- |
| Fraser | 210 / 19 | 8 | 10 | -- | 10 | 6 | 6 | -- | -- |
| Constellation | 3,721 / 346 | 94 | 120 | 175 | 120 | 60 | 28 | 21 | 34 |

| Name | SQ.FT./SQ.M. | Height | Banquet | Reception | Theatre | Classroom | Boardroom | U-Shape | Hollow Square |
|-----------------------------------|--------------|----------|---------|-----------|---------|-----------|-----------|---------|---------------|
| Grand Ballroom | 10,489 / 97 | 15 / 13 | 930 | 1350 | 1250 | 700 | 96 | 114 | 156 |
| Grand Ballroom A | 2,165 / 201 | 16 | 180 | 250 | 234 | 96 | 48 | 51 | 66 |
| Grand Ballroom B | 2,063 / 192 | 16 | 160 | 250 | 234 | 96 | 48 | 51 | 66 |
| Grand Ballroom C | 2,098 / 195 | 16 | 160 | 250 | 234 | 96 | 48 | 51 | 66 |
| Grand Ballroom D | 2,186 / 203 | 16 | 180 | 250 | 234 | 96 | 48 | 51 | 66 |
| Grand Ballroom AB | 4,227 / 393 | 16 | 380 | 475 | 520 | 192 | 96 | 99 | 114 |
| Grand Ballroom CD | 4,272 / 397 | 16 | 360 | 475 | 520 | 210 | 96 | 90 | 96 |
| Grand Ballroom A + Lower Passage | 3,182 / 296 | 16 | 270 | 370 | 364 | 192 | 54 | 63 | 84 |
| Grand Ballroom B + Upper Passage | 3,035 / 282 | 16 | 230 | 370 | 364 | 192 | 54 | 63 | 84 |
| Grand Ballroom C + Upper Passage | 3,070 / 285 | 16 | 230 | 370 | 364 | 192 | 54 | 63 | 84 |
| Grand Ballroom D + Lower Passage | 3,202 / 297 | 16 | 270 | 370 | 364 | 192 | 54 | 63 | 84 |
| Grand Ballroom AB + Passage | 6,217 / 578 | 16 | 570 | 900 | 868 | 336 | 96 | 111 | 126 |
| Grand Ballroom CD + Passage | 6,261 / 582 | 16 | 510 | 900 | 795 | 336 | 96 | 102 | 114 |
| Grand Ballroom AD + Lower Passage | 5,367 / 499 | 16 | 430 | 670 | 660 | 252 | 90 | 102 | 120 |
| Grand Ballroom BC + Upper Passage | 5,133 / 477 | 16 | 430 | 670 | 660 | 252 | 90 | 102 | 120 |
| Grand Ballroom Lower Passage | 1,017 / 95 | 16 | 50 | 90 | 112 | 32 | 42 | -- | -- |
| Grand Ballroom Upper Passage | 972 / 90 | 16 | 50 | 90 | 105 | 32 | 42 | -- | -- |
| Grand Ballroom Foyer | 3,722 / 346 | 10 / 9.6 | -- | 300 | -- | -- | -- | -- | -- |
| Name | SQ.FT./SQ.M. | Height | Banquet | Reception | Theatre | Classroom | Boardroom | U-Shape | Hollow Square |
| Gulf Islands A | 435 / 40 | 8 | 30 | 34 | 36 | 21 | 18 | -- | -- |
| Gulf Islands B | 321 / 30 | 8 | 20 | 24 | 25 | 15 | 14 | -- | -- |
| Gulf Islands C | 322 / 30 | 8 | 20 | 24 | 25 | 15 | 12 | -- | -- |
| Gulf Islands D | 252 / 23 | 8 | 10 | 20 | 22 | 8 | 8 | -- | -- |
| Gulf Islands BCD | 895 / 83 | 8 | 50 | 68 | 75 | 33 | 48 | -- | -- |
| Gulf Islands BC | 636 / 59 | 8 | 40 | 48 | 56 | 30 | 30 | -- | -- |
| Gulf Islands CD | 567 / 53 | 8 | 40 | 44 | 56 | 24 | 30 | -- | -- |
| Name | SQ.FT./SQ.M. | Height | Banquet | Reception | Theatre | Classroom | Boardroom | U-Shape | Hollow Square |
| Port Albemi | 884 / 82 | 8 | 50 | 70 | 83 | 42 | 30 | 21 | 24 |
| Port McNeill | 1,167 / 108 | 8 | 80 | 100 | 120 | 63 | 42 | 40 | 44 |
| Port Hardy | 572 / 53 | 8 | 30 | 50 | 38 | 21 | 18 | 16 | 20 |

NORTH TOWER

B-TOWER

SOUTH TOWER

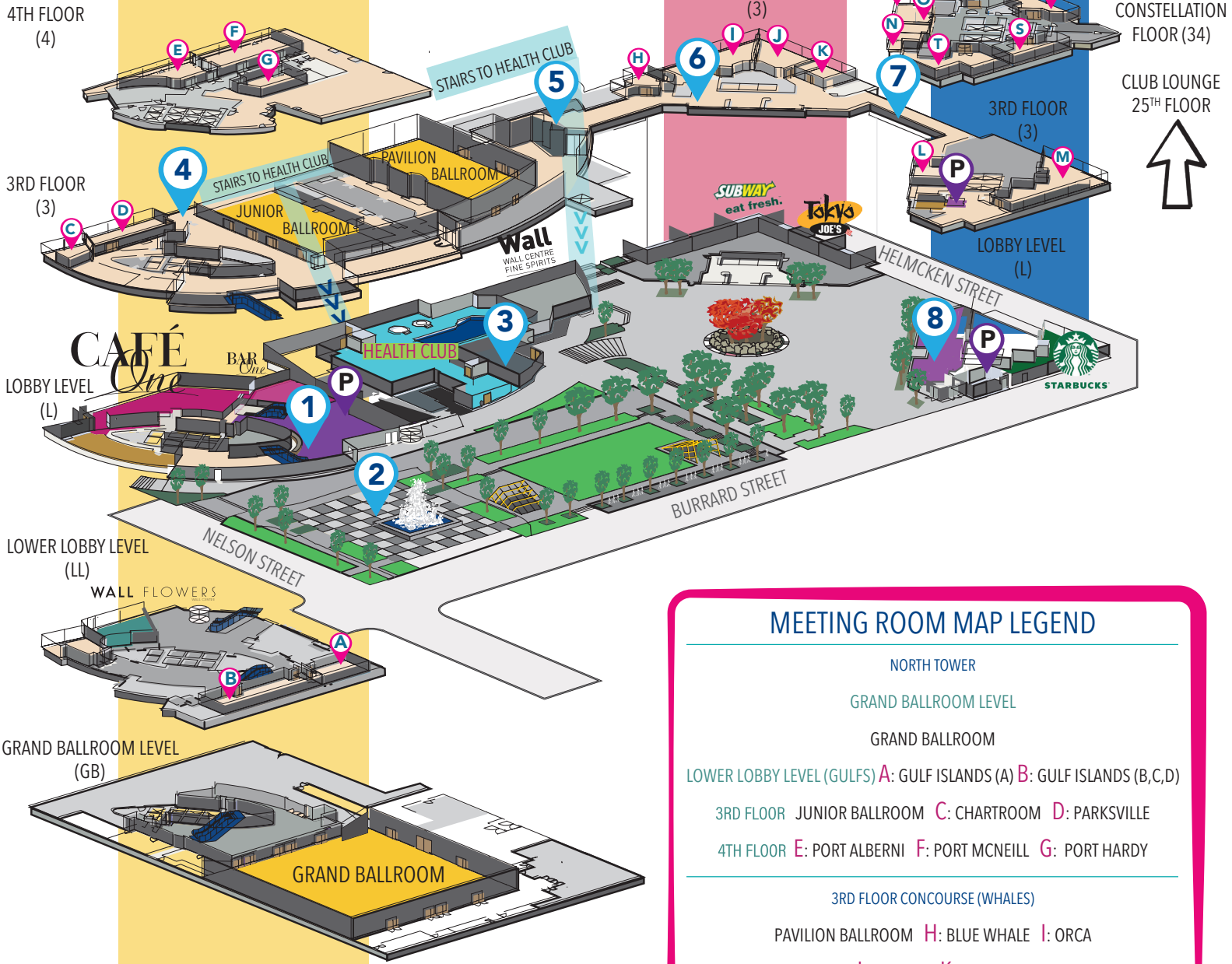

HOTEL FEATURES GUIDE

- | | |
|-----------------------------------|------------------------------------|
| 1. NORTH TOWER LOBBY | 5. STAIRS TO HEALTH CLUB (OUTDOOR) |
| 2. FOUNTAIN SQUARE | 6. BUSINESS CENTRE |
| 3. HEALTH CLUB | 7. 3RD FLOOR CONCOURSE SKYWALK |
| 4. STAIRS TO HEALTH CLUB (INDOOR) | 8. SOUTH TOWER LOBBY |

MEETING ROOM MAP LEGEND

NORTH TOWER

GRAND BALLROOM LEVEL

GRAND BALLROOM

LOWER LOBBY LEVEL (GULFS) A: GULF ISLANDS (A) B: GULF ISLANDS (B,C,D)

3RD FLOOR JUNIOR BALLROOM C: CHARTROOM D: PARKSVILLE

4TH FLOOR E: PORT ALBERNI F: PORT MCNEILL G: PORT HARDY

3RD FLOOR CONCOURSE (WHALES)

PAVILION BALLROOM H: BLUE WHALE I: ORCA

J: FINBACK K: BELUGA

SOUTH TOWER

3RD FLOOR L: CRACKED ICE M: AZURE

4TH FLOOR N: COLUMBIA O: FRASER P: HUDSON Q: GALIANO

R: VANCOUVER S: BURRARD T: GRANVILLE